

WARNING: WHEN PRINTING TEMPLATES FROM THE WEB SITE, CHANGE PRINTER SETTINGS TO “PRINT TO FULL SIZE” (100%). DO NOT SCALE TO FIT.

DETEX CORPORATION, 302 DETEX DRIVE, NEW BRAUNFELS, TEXAS 78130 (830)629-2900 1-800-729-3839 FAX(830)620-6711
E-Mail: detex@detex.com Internet: www.detex.com

INSTALLATION INSTRUCTIONS FOR THE ECL-230D/230D-PH EXIT CONTROL LOCK

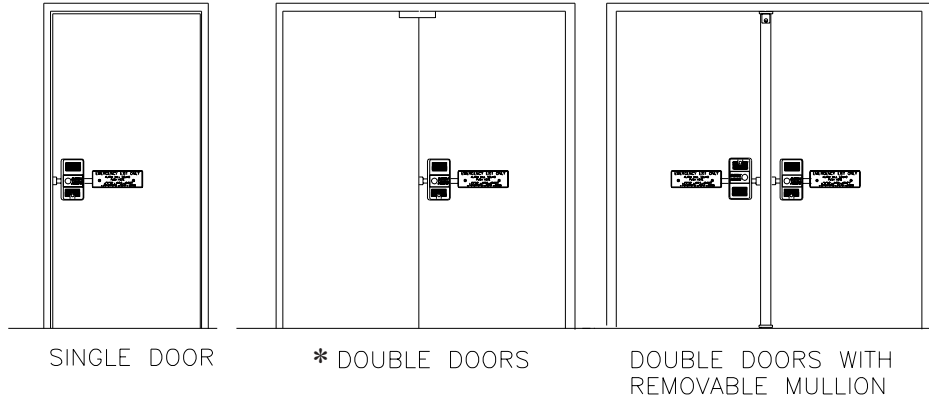

FIG. 1.- APPLICATIONS, ECL-230D

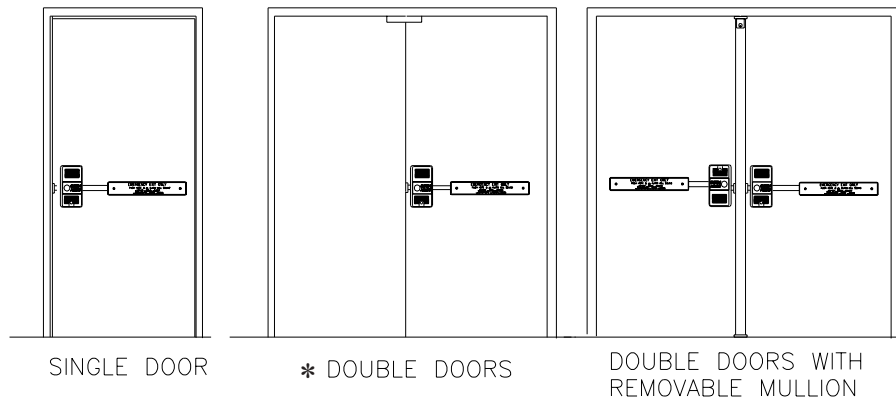

FIG. 2.- APPLICATIONS, ECL-230D-PH

* Used with DDH-2250 & ECL-435K or VRA-143

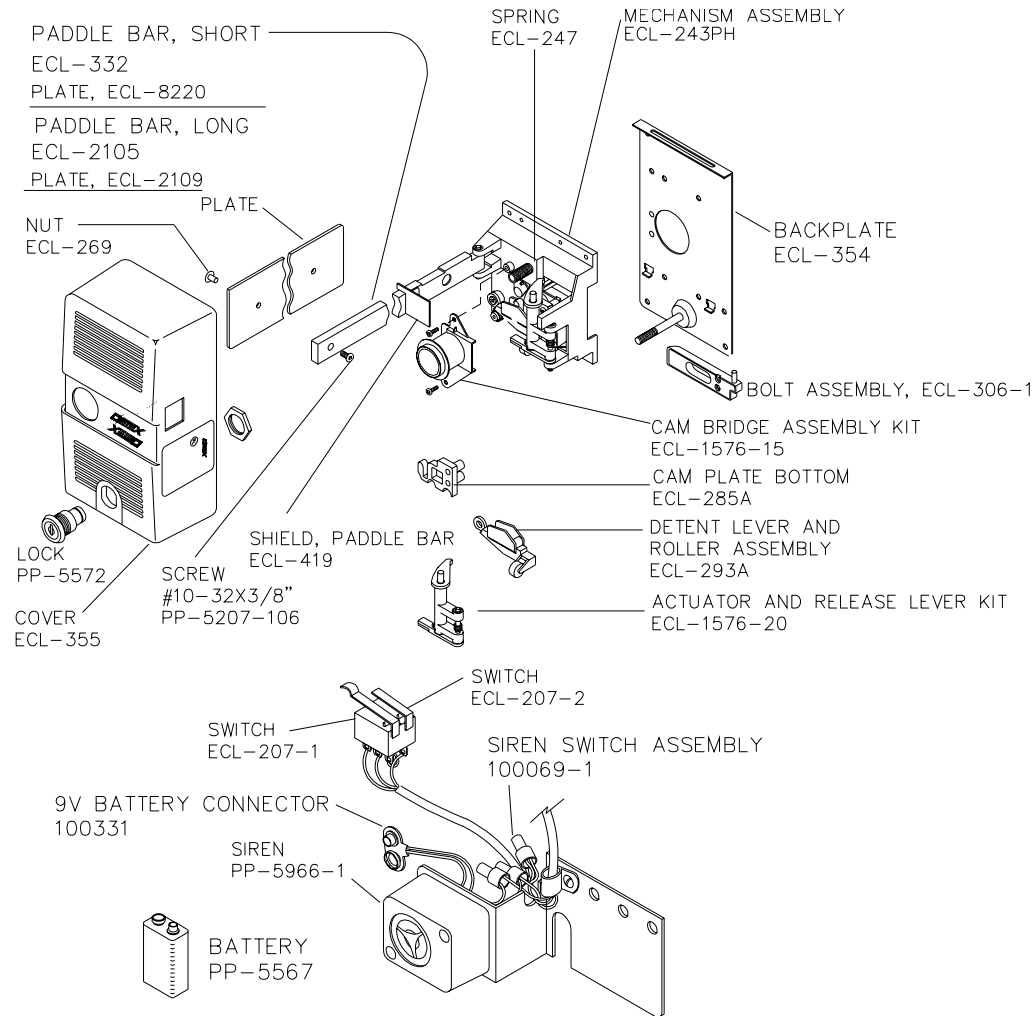

FIGURE 3.- ILLUSTRATED PARTS BREAKDOWN

PROBLEMS?

Contact Customer Service at **1-800-729-3839**

WARRANTY

The Detex Exit Control Lock you have purchased is warranted to be free of defects in material and workmanship when properly installed, used and maintained according to instructions. We will, for a period of **five (5)** years from the date of purchase, repair or replace any part which, upon our examination, proves to be defective under normal use. This does not apply to batteries or to damage from battery leakage. This warranty will be honored only upon presentation of proof that the product covered thereby was purchased directly from an authorized Detex Distributor. **WE SHALL NOT BE LIABLE FOR ANY DIRECT, INCIDENTAL OR CONSEQUENTIAL LOSS OR DAMAGE ARISING OUT OF THE FAILURE OF THIS EXIT CONTROL LOCK TO OPERATE**

NOTE: DIMENSIONS MAY NOT BE ACCURATE WHEN PRINTING FROM WEBSITE
PLEASE CONFIRM DIMENSIONS WITH RULER BEFORE USE

TEMPLATE A

TPL-230D-1

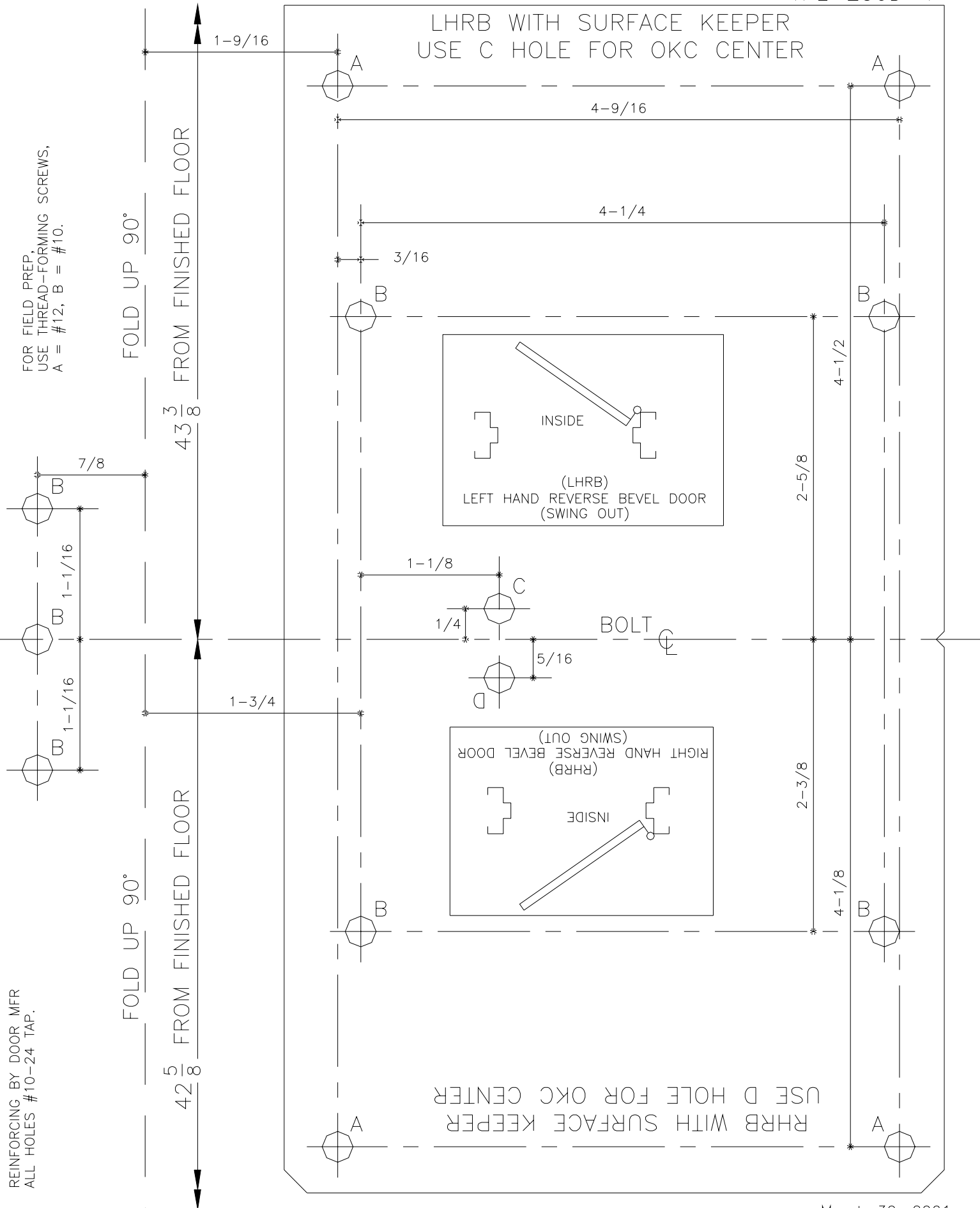

NOTE: DIMENSIONS MAY NOT BE ACCURATE WHEN PRINTING FROM WEBSITE
PLEASE CONFIRM DIMENSIONS WITH RULER BEFORE USE

TEMPLATE B

TPL-230D-2

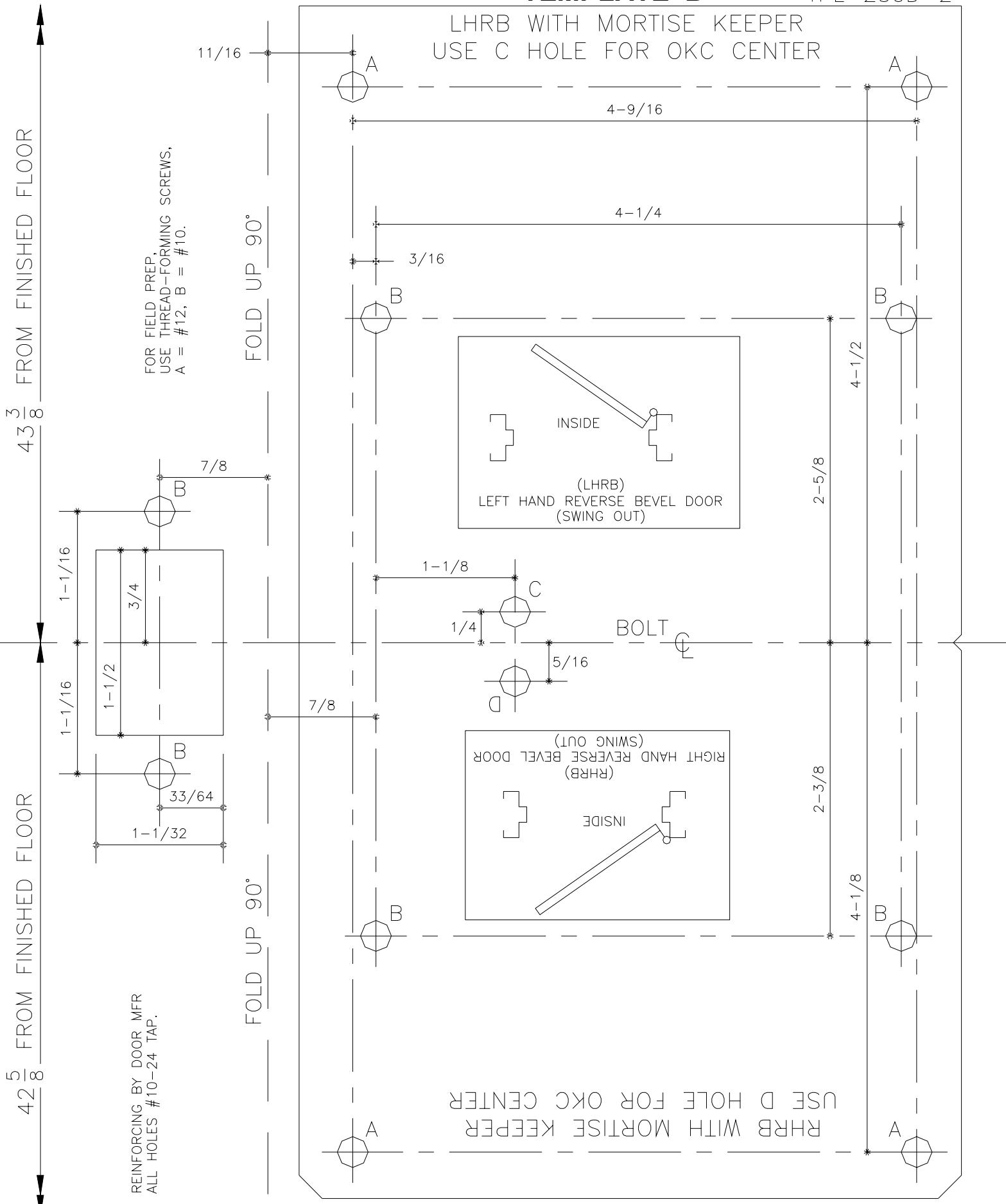

DOOR AND FRAME PREPARATION

TWO TEMPLATES ARE PROVIDED. SELECT THE PROPER ONE, MORTISE OR SURFACE KEEPER, AND FOLD IT AS DIRECTED. DRAW A LINE ON THE DOOR, FOR CENTERLINE OF BOLT. HEIGHT OF THIS LINE FROM FINISHED FLOOR AS SHOWN ON THE TEMPLATE. BUT THE DOOR FIRMLY AGAINST THE DOOR STOP. POSITION THE TEMPLATE ON THE DOOR.

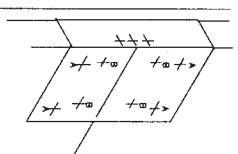

MARK THE HOLE CENTERS ON THE DOOR AND FRAME, 4 'A' HOLES AND 4 'B' HOLES AND 2 OR 3 HOLES IN THE FRAME

IF THE OKC IS TO BE INSTALLED, MARK THE OKC HOLE CENTER, AT 'C' OR 'D' AS DIRECTED. BORE A HOLE THROUGH THE DOOR FOR THE RIM CYLINDER. (1-1/4" DIA FOR THE DETEX CYLINDER.) DRILL 'A' HOLES, FOR #12 SCREWS, #18 DRILL DRILL 'B' HOLES, FOR #10 SCREWS, #25 DRILL DRILL HOLES IN FRAME FOR #10 SCREWS. INSTALL THE KEEPER WITH #10 SCREWS.

INSTALL BACKPLATE

IF THE OKC IS TO BE INSTALLED, DO SO AS SHOWN IN FIGURE 4. INSTALL THE BACKPLATE WITH #12 SCREWS IN THE 'A' HOLES.



INSTALL MECHANICAL ASSEMBLY

INSTALL THE IKC AS SHOWN IN FIGURE 5. INSTALL THE ACTUATING BAR AS SHOWN IN FIGURE 6. INSTALL THE MECHANICAL ASSEMBLY WITH 4 #10 SCREWS IN THE 'B' HOLES.

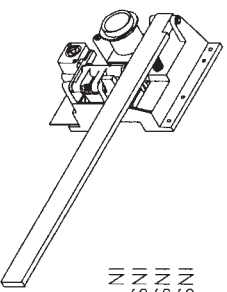

INSTALL COVER

INSERT THE ACTUATING BAR THROUGH THE HOLE IN THE COVER AND SLIDE THE COVER OVER THE BAR. INSTALL THE PADDLE ON THE BAR. HOOK THE COVER ON THE BACKPLATE AND LOCK THE COVER.

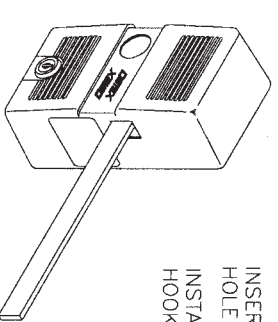

5

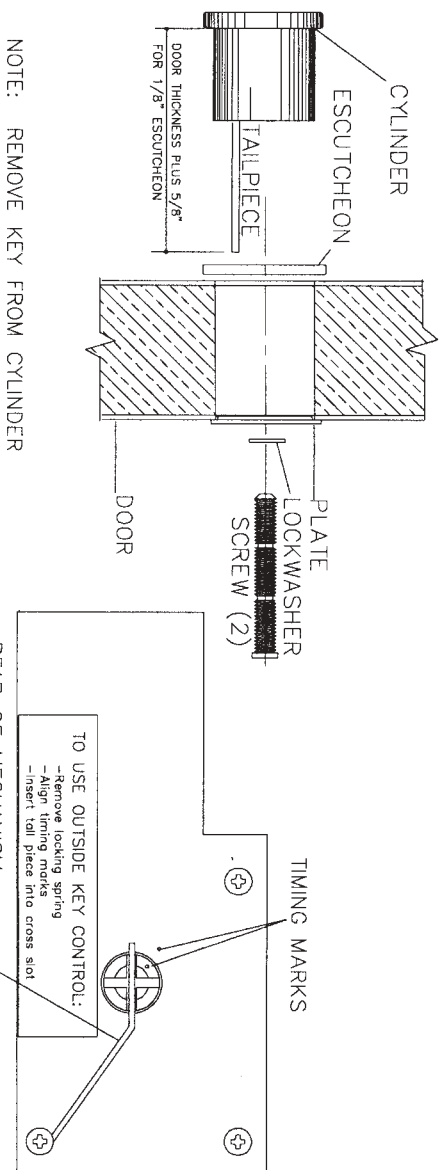
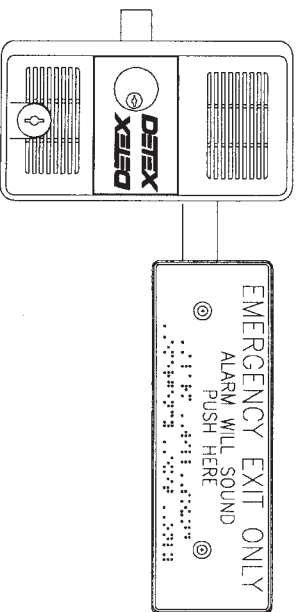

NOTE: REMOVE KEY FROM CYLINDER

NOTE: DO NOT REMOVE THE PUSH NUT REAR OF MECHANISM

FIG. 4.— OKC INSTALLATION

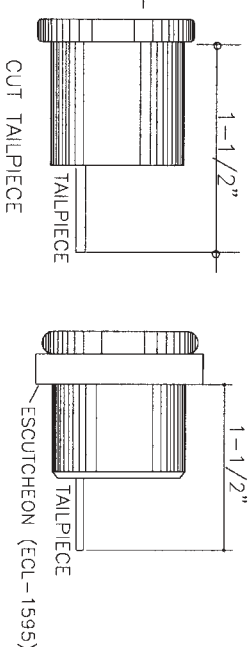

REMOVE CAM BRIDGE SEE FIGURE 3 ON PAGE 2

REMOVE KEY AND INSERT CYLINDER SECURE THE CYLINDER
NOTE: ONE HOLE FOR THE MOUNTING SCREWS IS COVERED BY THE CAM. INSTALL A SCREW IN THE OPEN HOLE FIRST. BE SURE TO USE A LOCKWASHER UNDER THE HEAD OF THE SCREW.
INSERT THE KEY AND TURN IT TO EXPOSE THE SECOND HOLE. INSTALL THE SCREW AND LOCKWASHER. TURN THE KEY IN BOTH DIRECTIONS. THERE MUST NOT BE ANY FRICTION OR BINDING. REMOVE THE KEY.

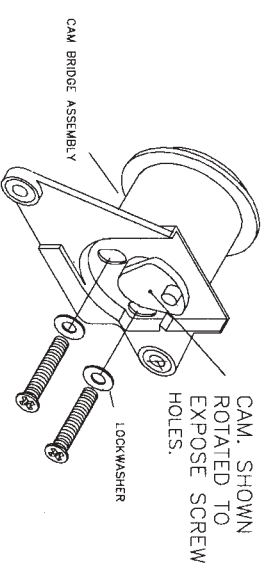

REAR OF CAM BRIDGE
NOTE: THE CAVITY IN THE CAM BRIDGE IS DESIGNED FOR A 5-PIN RIM CYLINDER. IF A LONGER CYLINDER IS USED CONTACT DETEX TO OBTAIN A COLLAR TO MAKE UP THE GAP PART NUMBER ECL-1595.

NOTE: BEFORE REINSTALLING CAM BRIDGE ASSEMBLY, REMOVE KEY FROM CYLINDER AND MAKE SURE BOTH MICRO-SWITCHES ARE PROPERLY SEATED ON PLASTIC BASE (ECL-308). SECURE CAM BRIDGE. INSERT KEY IN IKC CYLINDER AND CYCLE SWITCHES BY TURNING KEY CLOCKWISE/COUNTER-CLOCKWISE 2 TO 3 TIMES. CONNECT BATTERY, SECURE COVER AND TEST UNIT.

FIG. 5.— IKC INSTALLATION

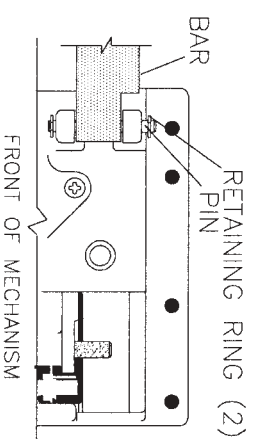

FIG. 6.— ACTUATING BAR INSTALLATION

TOOLS AND SUPPLIES REQUIRED

PENCIL
TAPE FOR TEMPLATES
CENTER PUNCH
HAMMER
DRILL MOTOR
DRILL BITS
SCREWDRIVERS
LINESMAN'S CUTTERS TO CUT THE RIM CYLINDER TAILPIECE
TAPE MEASURE
COMBINATION SQUARE

EQUIVALENT METRIC DIMENSIONS

INCHES	MILLIMETERS
0.150	4
0.169	4
7/16	11
1	25
1-1/4	32
1-1/2	37
8	203
40-5/16	1,024

TEST AND TROUBLESHOOTING

COVER LOCK KEY DOES NOT TURN
a) CONFIRM KEY NUMBER ON CYLINDER FACEPLATE MATCHES NUMBER ON THE KEY
b) LUBRICATE WITH WD-40 INSIDE KEY CONTROL. (IKC) KEY IS HARD TO TURN
c) OPEN DOOR. WITH DOOR OPEN, TURN THE KEY TO EXTEND AND RETRACT THE BOLT
d) IF THE KEY TURNS FREELY, THE PROBLEM IS MISALIGNMENT OF THE BOLT AND KEEPER
e) CLOSE THE DOOR AND EXTEND THE BOLT
f) CHECK THE BOLT ALIGNMENT AND ADJUST THE KEEPER AS REQUIRED
g) IF THE KEY IS HARD TO TURN WHILE THE DOOR IS OPEN, THE PROBLEM IS BECAUSE THE CYLINDER TAILPIECE IS TOO LONG. REMOVE THE CYLINDER AND SHORTEN THE TAILPIECE.

THE IKC KEY CANNOT BE REMOVED WHEN THE BOLT IS EXTENDED OR RETRACTED.
a) REMOVE THE CAM BRIDGE ASSEMBLY
b) REMOVE THE CYLINDER
c) ALIGN THE TIMING MARKS ON THE HOUSING
d) REMOVE THE KEY FROM THE CYLINDER
e) INSTALL THE CYLINDER
f) SECURE

COVER CANNOT BE INSTALLED WHEN USING A 7-PIN CYLINDER
CONFIRM THAT THE SPACER DOES NOT EXCEED 1/4"
UNIT DOES NOT SOUND
a) CHECK/REPLACE BATTERY
b) CHECK FOR LOOSE OR BROKEN BATTERY LEADS
OKC KEY IS HARD TO TURN
SEE FIGURE 4
CANNOT REMOVE THE OKC KEY WHEN THE BOLT IS EXTENDED OR RETRACTED.
SEE FIGURE 4